

SINCE 1908
wessels
 company

SUBMITTAL

**TYPE: WESS-VENT – HIGH VELOCITY
 AIR & DIRT SEPARATOR**

MODELS: WVA-2-HV TO WVA-16-HV
 SUBMITTAL SHEET No. WVA-HV-117 Date: 6/09

JOB _____ Unit Tag No. _____ Engineer _____ Contractor _____	Wessels Representative _____ _____ _____ Order No. _____ Date _____ Submitted By _____ Date _____ Approved By _____ Date _____
---------------------------------------------------------------------------	-----------------------------------------------------------------------------------------------------------------------------------------------

DESCRIPTION

Wessels WVA-HV (High Velocity) series Air & Dirt Separators are designed to eliminate entrained air and separate debris associated with start-up and maintenance of any hydronic system. The design incorporates a skim valve, used to eliminate floating debris, and an air vent to automatically release air from the separator. The design and construction conforms to ASME Section VIII, Div.1

CONSTRUCTION

Shell: Carbon Steel
 Coalescing Medium: Stainless Steel
 Blow Down Valve (optional): Bronze
 Skim Valve (optional): Bronze
 Vent: (optional): Stainless Steel

PERFORMANCE LIMITATIONS

Maximum Design Temperature: 250°F
 Maximum Design Pressure: 125 PSIG

DIMENSIONS AND WEIGHTS

MODEL	FLANGE SIZE	FLOW GPM	D (IN.)	H (IN.)	W (IN.)	A (IN.)	B (IN.)	WT LBS.
WVA-2-HV	2	105	4	33	15 1/4	16 1/2	8 5/8	76
WVA-2.5-HV	2 1/2	155	5	33	15 3/4	16 1/2	8 5/8	99
WVA-3-HV	3	225	6	42	20 1/4	21	8 5/8	139
WVA-4-HV	4	405	8	42	20 5/8	21	8 5/8	219
WVA-5-HV	5	630	10	59	27 3/4	29 1/2	8 5/8	236
WVA-6-HV	6	910	12	59	27 3/4	29 1/2	8 5/8	405
WVA-8-HV	8	1610	16	75	33 5/8	37 3/4	8 5/8	639
WVA-10-HV	10	2450	20	92	37 1/2	46	8 5/8	1045
WVA-12-HV	12	3500	24	110	42 1/2	55	8 5/8	1630
WVA-14-HV	14	4,800	30	110	48	55	8 5/8	2400
WVA-16-HV	16	6,250	32	147	48	73 1/2	8 5/8	3000

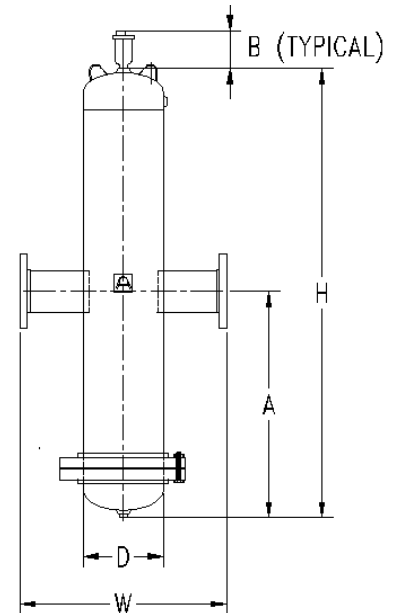

SPECIFICATION

Furnish and install on the plans and described herein, a Wess-Vent WVA-HV High Velocity Air & Dirt Separator as manufactured by Wessels Company. Each separator must be designed with a blowdown valve, skim valve, and automatic air vent. The separator must also utilize in its design a stainless steel coalescing medium to aid in the separation of air and dirt in the system entrained water. The separator must be constructed in accordance with the latest revision of the ASME Boiler and Pressure Vessel Code and stamped 125 psi working pressure.

Each separator shall be Wessels model WVA- ____ -HV or approved equal.